

MAINTENANCE
OPERATIONS

Praktika T-02(K) turnstile







Contents

1. General information	4
2. Conditions for maintenance	5
3. Partial disassemble of the turnstile	5
4. Checking turnstile parts	15
5. Lubrication of moving parts.....	16
6. Assembling and performance checking of the turnstile	16

1. General information

1.1. During operation of the turnstile in order to maintain efficiency and to ensure calculated lifetime the maintenance operation of the turnstile shall be carried out periodically, including the warranty period (hereinafter MO).

1.2. MO shall be performed once in 6 months. Should there be any failure MO should be performed immediately after repair works.

1.3. During MO it is recommended to carry out the work by two qualified mechanical and electrical engineers, acquainted with the manual.

1.4. MO includes the following scope of work: partial disassemble of the turnstile, cleaning of load-bearing frame, checking of parts and units fixation, lubrication of subject to wear parts of actuating device, checking of belt tension, setting the dismantled parts and a general inspection of the turnstile.

2. Conditions for maintenance

CAUTION! It is strictly forbidden to carry out work with powered turnstile. Failure to follow these safety requirements could result in damage to human life and health, total or partial loss of product workability and (or) auxiliary equipment.

CAUTION! Do not remove motherboard located under the LED panel. Otherwise the manufacturer will void the product warranty.

CAUTION! It is not recommended to adjust the limitation units of solenoid stroke, Hall sensor bracket and spring tension. These components are adjusted at the factory. Violation of these adjustments may lead to failures of the whole electromechanical system.

3. Partial disassemble of the turnstile

To get access to all elements of the turnstile it is necessary to perform a partial disassembly. Scope of work includes the dismantling of the LED panel, the hatch with a lock and a lower panel (Fig. 1).

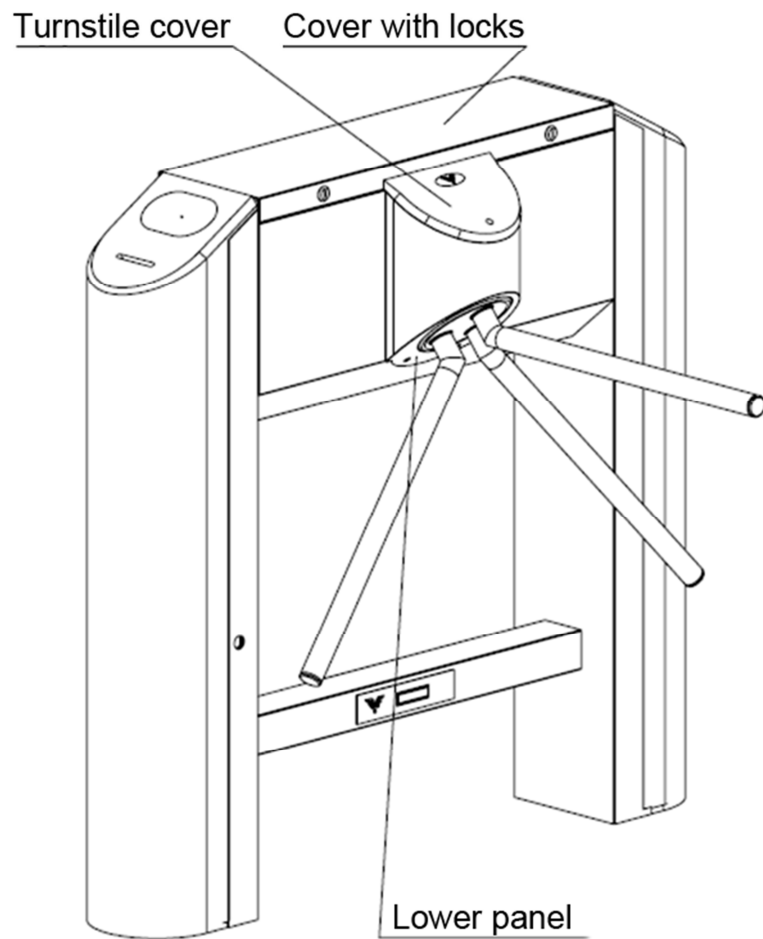

Fig. 1

Press the button 4 on the RC panel (Fig. 2) and fold the arms. The result is shown in Fig. 3.

3.2 Turn off turnstile power supply and disconnect it from the electrical network.

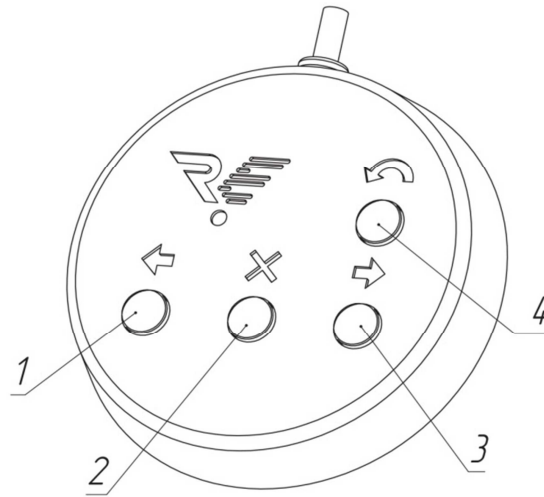

Fig. 2

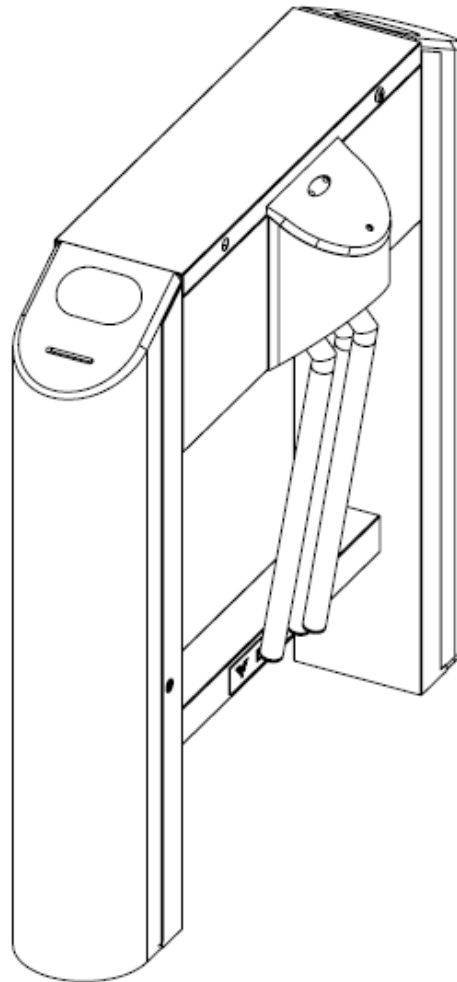

Fig. 3

3.3. Open using the key and remove the cover with locks (see Fig. 1).

3.4 Removing turnstile cover:

- Remove two self-tapping screws using a crosshead screwdriver with a magnetic tip (Fig. 4)

CAUTION! Make sure that the fittings do not fall into the turnstile mechanism.

- slide the turnstile cover in the direction indicated by Fig. 5, and lift it up.

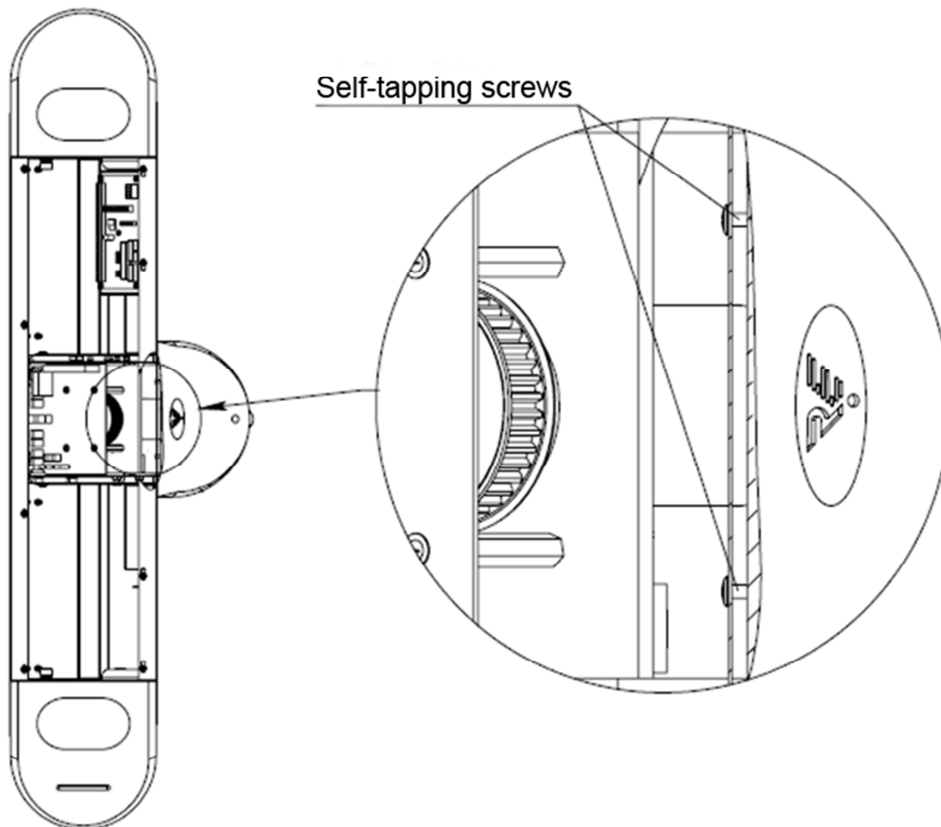

Fig. 4

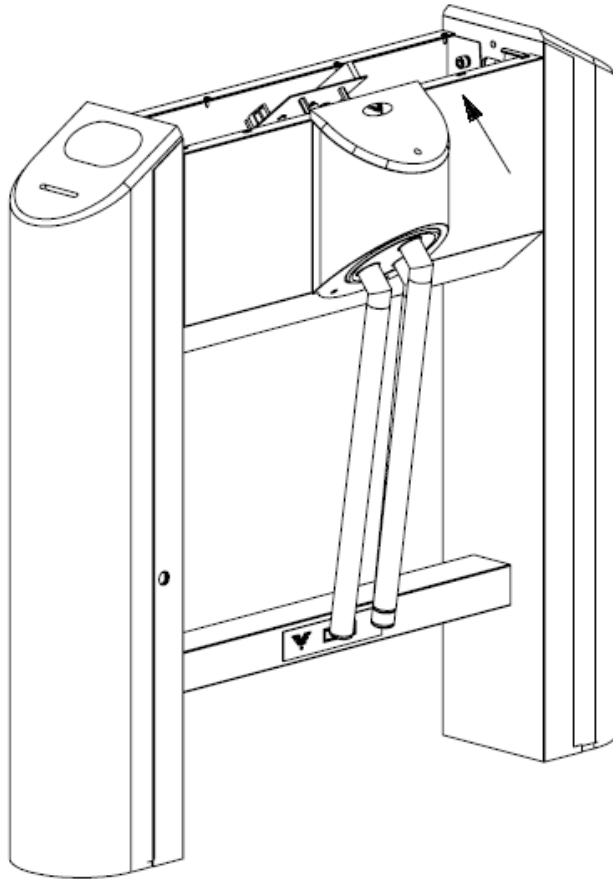

Fig. 5

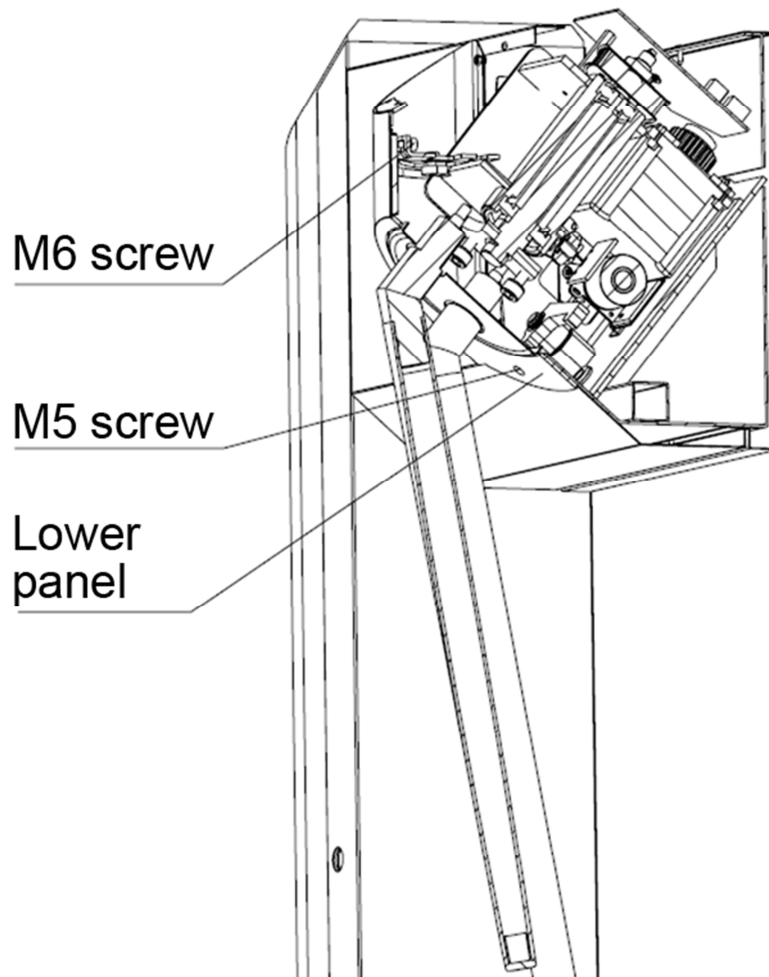

Fig. 6

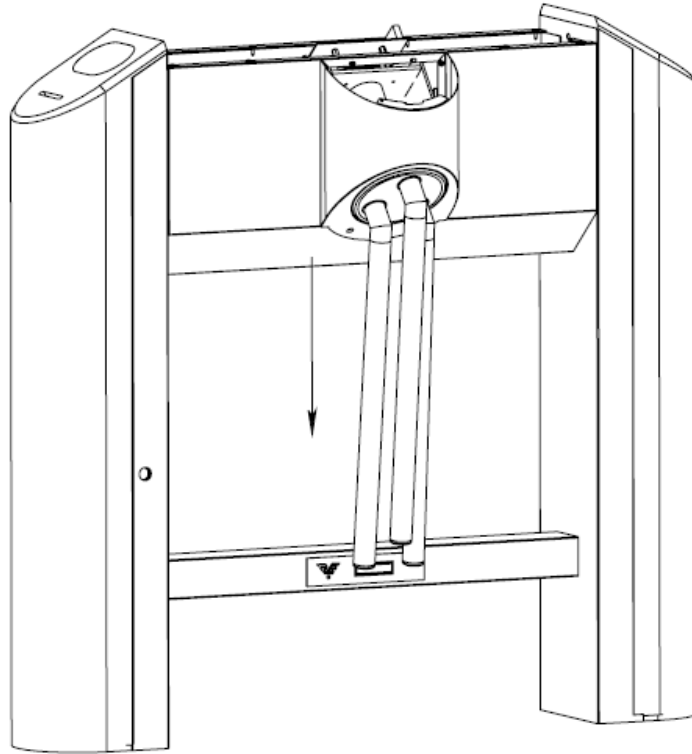

Fig. 7

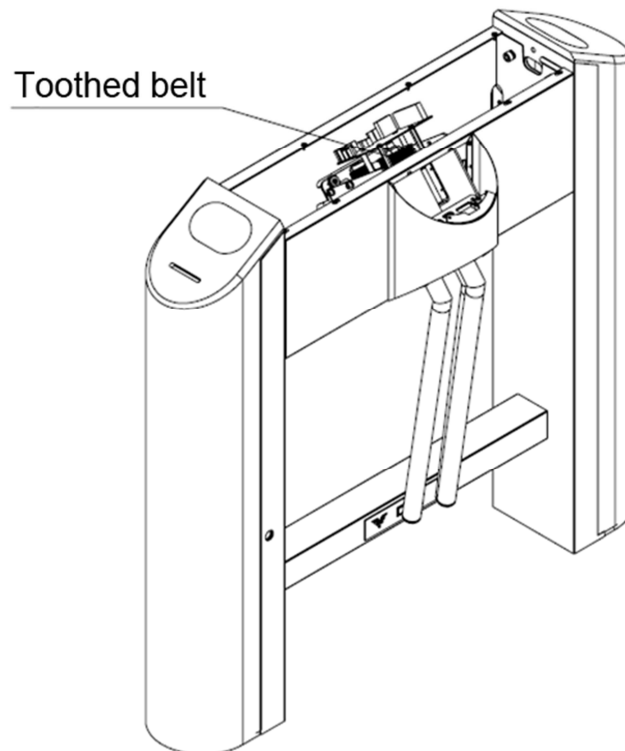

Fig. 8

3 drops of oil

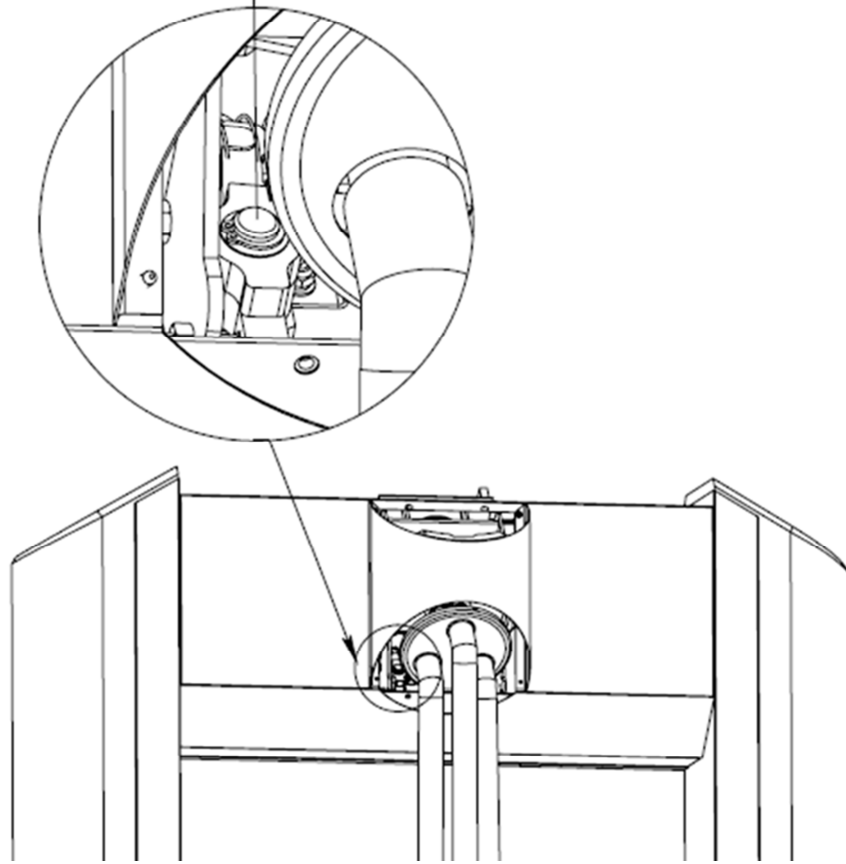

Fig. 9

3 drops of oil

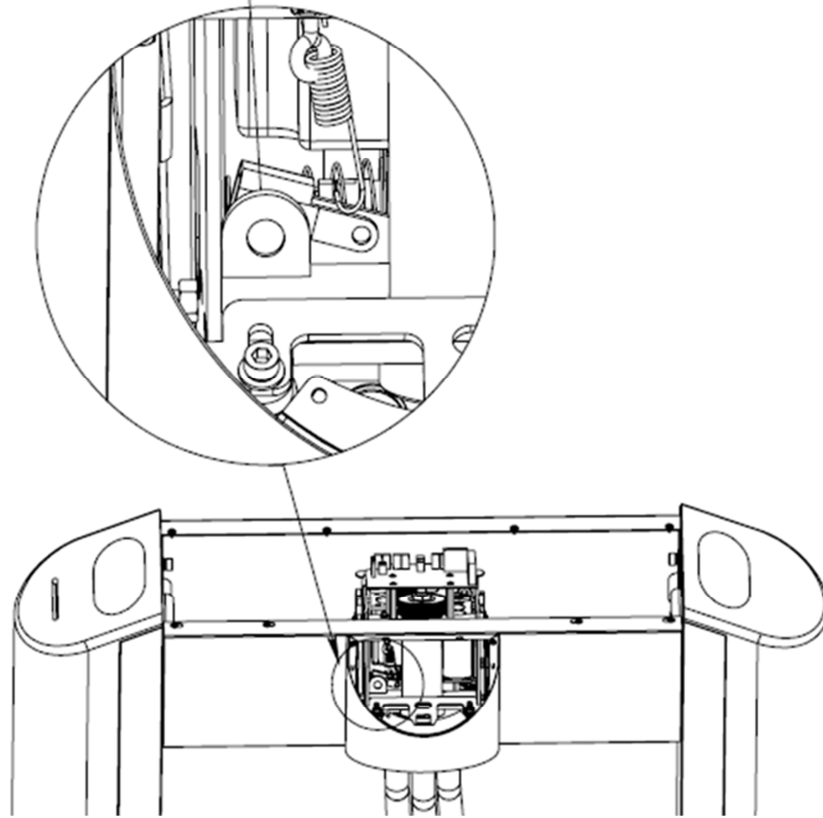

Fig. 10

3 drops of oil

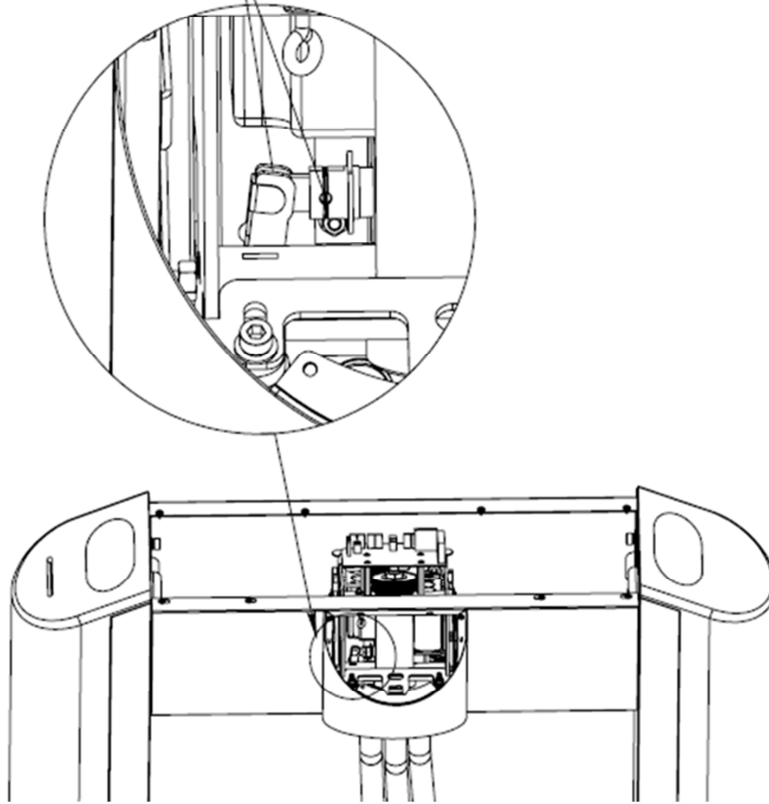

Fig. 11

3 drops of oil

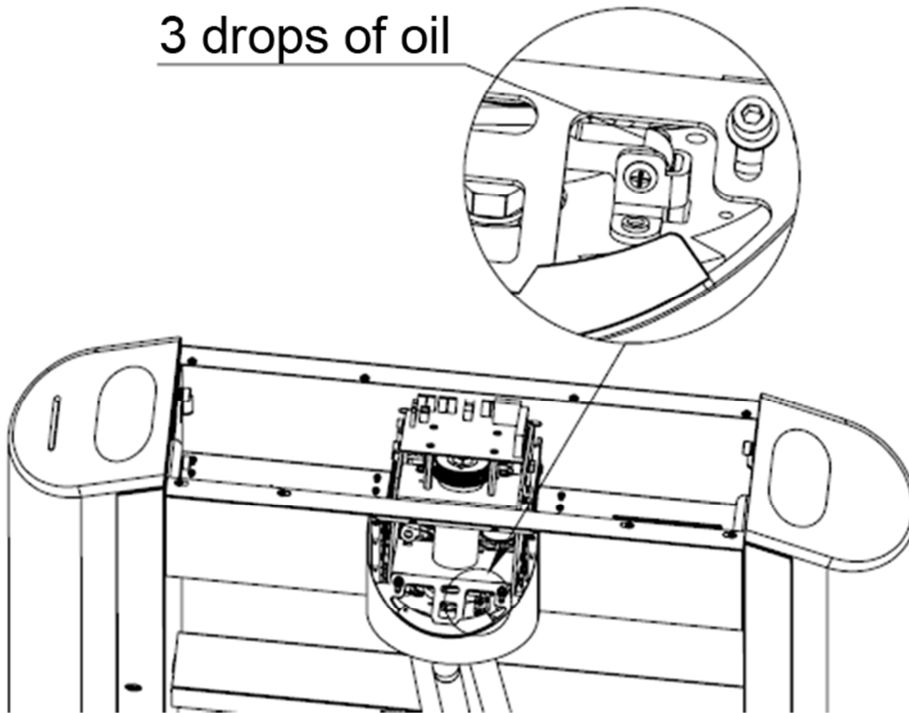

Fig. 12

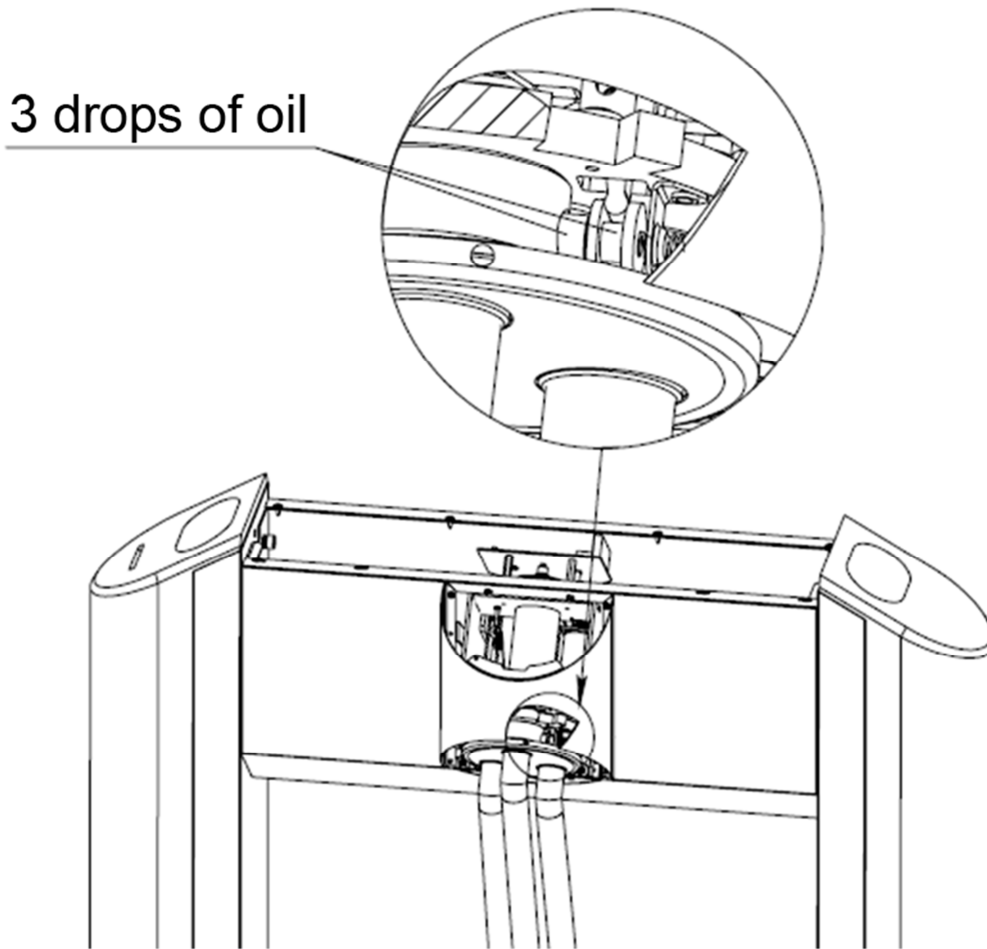

Fig. 13

3.5. Removing the bottom cover of turnstile:

- Remove two M6 DIN7985 screws (Fig. 6);
- Remove one M6 GOST11738-84 screw (Fig. 6);
- Remove the bottom cover by moving it vertically down, as shown in Fig. 7.

4. Checking turnstile parts

- 4.1. Clean the load-bearing frame from contamination.
- 4.2. Check that all cables are securely connected.
- 4.3. If necessary check and tighten the screw joints of turnstile:

4.4. Check the condition of the toothed belt and its tension (Fig. 8).

5. Lubrication of moving parts

Lubrication is made with 2-3 drops of engine oil (viscosity grade 5W-20).

5.1. The rotation axis of the stopper unit (Fig. 9).

5.2. The rotation axis of the roller lever (Fig. 10).

5.3. Clips between the stopper unit and the solenoid (Fig. 11). Elements are located behind the roller lever shown on Fig. 10

5.4. The rotation axis of unlocking arms cam (Fig. 12).

5.5. The connection of lock pin and arms-unblocking cams (Fig. 13). The operation shall be done for each arm. Hole in Fig. 13 is shown in the conventional manner.

6. Assembling and performance checking of the turnstile

6.1. If any troubles or defects are found out during MO it is advised to contact our service department for advice, contact details are available online:

www.oxgard.com

6.2. If it is necessary to repair damaged painted surfaces, powder paint identical to the damaged (RAL9005) shall be used in accordance with instructions for its use.

6.3. Reassemble the turnstile in reverse order.

6.4. Turn on the turnstile and perform functionality check by making several passes and activating “antipanic” mode.



6.5. If there is no extraneous noise or any abnormality in the turnstile work it is ready for operation.



ООО "Vozrozhdenie"

192289 Saint Petersburg

Sofiyskaya st., 66

Tel./fax +7 (812) 366 15 94

www.oxgard.com

info@oxgard.com

